

CONTRONETIX

XRT1500/XRT3000



• XRT1500 • XRT3000

Features

- Rack/Tower Convertible Design
- Patented Minic LCD Display can be rotated
- True Online Double Conversion
- High Output Power Factor at 0.9PF
- Comprehensive display allows easy monitoring and access of UPS status
- Smart SNMP works with either USB or RS232 together
- Hot-Swappable Battery
- Efficiency up to 90%
- Estimated Remaining Time displayed on the LCD
- Support Economic(ECO) Operation Mode
- Matching Battery Pack
- Optional Powerful Charger
- Cold Start
- Power Shedding May Turn Off Uncritical Load in Battery Backup
- Emergency Power Off
- Frequency Converter Mode Is Settable

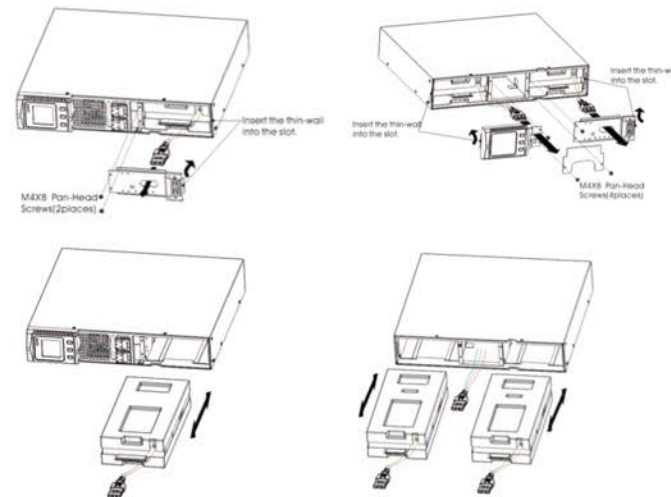

Easy for maintenance hot-swappable battery



Multifunctional bracket

Rack-Tower convertible

Battery Cabinets (Optional)



SNMP



Mini dry contact card

Technical Specifications:

MODEL	XRT1500	XRT3000	
Capacity (VA/Watts)	1500 / 1350	3000 / 2700	
Phase	Single phase with ground		
INPUT			
Nominal voltage	200/208/220/230/240Vac or 100/110/115/120/127Vac		
Input voltage range	55-150Vac or 110-300Vac @ 60% load, 80-145Vac or 160-300Vac @ 100% load		
Frequency range	45-55Hz/55-65Hz (Auto-detect)		
Power factor	≥0.99 @Nominal voltage(100% load)		
OUTPUT			
Output voltage	200/208/220/230/240Vac or 100/110/115/120/127Vac		
Power factor	0.9		
Voltage regulation	±1%		
Frequency range (Synchronized range)	45-55Hz/56-64Hz		
Frequency range (Batt. mode)	50Hz/60Hz±0.1Hz		
Current crest ratio	3:1		
Harmonic distortion	≤3% THD(Linear load) ≤6% THD(Non-linear load)		
Transfer time	AC to DC	Zero	
	Inverter to bypass	4ms(Typical)	
Waveform	Pure sinewave		
EFFICIENCY			
AC mode	88%	90%	
Battery mode	83%	86%	
BATTERY			
Standard model	Battery type	12V/9AH	
	Numbers	3	
	Backup time	Estimated remaining time displayed on the LCD	
	Typical recharging time	4 hours recover to 90% capacity	
	Charging current (Max.)	1.0A	
	Charging voltage	41.1Vdc ±1%	82.1Vdc ±1%
Long run model (Only HV model)	Battery numbers	Depending on the capacity of external batteries	
	Charging current (Max.)	6A/12A(Double board)	
	Charging voltage	41.1Vdc ±1%	82.1Vdc ±1%
INDICATORS			
LCD	Load level, battery level, AC mode, battery mode, bypass mode and fault indicators		
ALARM			
Battery mode	Beeping every 4 seconds		
Battery low	Beeping every second		
Overload	Beeping twice every second		
Fault	Continuously beeping		
PHYSICAL			
Standard model	Dimension, DxWxH (mm)	430×440×86.5	710×440×86.5
	Net weight (kgs)	17.8	23.3
Long run model	Dimension, DxWxH (mm)	430×440×86.5	552×440×86.5
	Net weight (kg)	8.2	11.3
ENVIRONMENT			
Humidity	20-90% (Non-condensing)		
Noise level	<50dB @ 1 Meter		
MANAGEMENT			
Smart RS232/USB	Supports windows 2000/2003/XP/Vista/2008/windows 7/8 Linux, FreeBSD and MAC		
Optional SNMP	Power management from SNMP manager and web browser		

Specifications are subject to change without prior notice.